

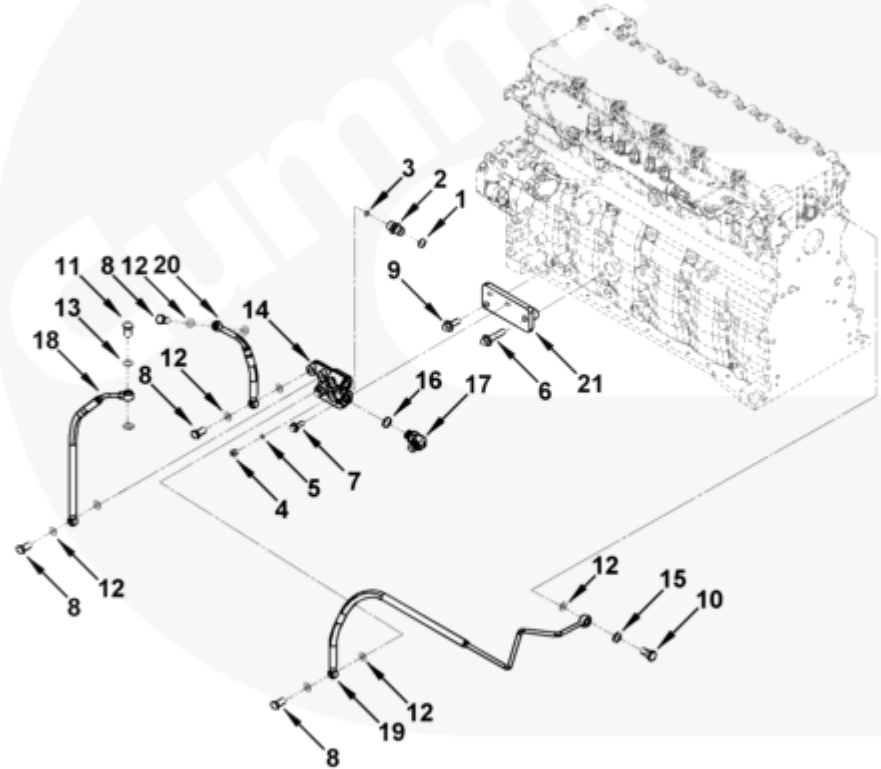

## Parts Catalog - Option Detail

Electronic Parts Catalog - Option Detail				
Option	Group	Graphic	Film Card	Date
FT9094-04	06.03	ft954zq	T	19-SEP-06
<b>Engines</b>	4B3.9, 6A3.4, 6B5.9, B GAS INTERNATIONAL CM556, B4.5, B4.5 CM2350 B129B, B4.5 CM2350 B146C, B4.5 CM2350 B147B, B4.5 RGT, B4.5S, B5.9 G, B5.9 GAS PLUS CM556, B5.9 LPG, B5.9 LPG PLUS CM556, B6.7 CM2350 B121B, B6.7 CM2350 B135B, B6.7 CM2350 B136C, B6.7 CM2350 B148B, B6.7 G CMOH6.0 B125, B6.7N CM2380 B150B, B6.7S, F3.8 CM2350 F120B, F3.8 CM2350 F128C, F3.8 CM2350 F132B, F3.8 F102, G3.9, G5.9, G5.9 CM558, ISB (CHRYSLER), ISB CM2150, ISB CM2150 E, ISB CM550, ISB CM850, ISB/ISD4.5 CM2150 B119, ISB/ISD4.5 CM2150 SN, ISB/ISD6.7 CM2150 B120, ISB/ISD6.7 CM2150 SN, ISB/ISD6.7 CM2880 B126, ISB3.9 CM2220 B107, ISB4.5 CM2150, ISB5.9G CM2180, ISB6.7 2010 DCX PICKUP, ISB6.7 2013 DCX CHASSIS CAB, ISB6.7 CM2150 SQ, ISB6.7 CM2250, ISB6.7 CM2350 B101, ISB6.7 CM2350 B103, ISB6.7 CM2350 B142, ISB6.7 CM2670 B153B, ISB6.7 G CM2180 B118, ISBE CM2150, ISBE CM800, ISBE2/ISBE3 CM850, ISBE4 CM850, ISD4.5 CM2150, ISD6.7 CM2880 D101, ISF2.8 CM2220, ISF2.8 CM2220 AN, ISF2.8 CM2220 EC, ISF2.8 CM2220 ECF2, ISF2.8 CM2220 F101, ISF2.8 CM2220 F117, ISF2.8 CM2220 F122, ISF2.8 CM2220 F126, ISF2.8 CM2220 F129, ISF2.8 CM2220 IAN, ISF3.8 CM2220, ISF3.8 CM2220 AN, ISF3.8 CM2220 F103, ISF3.8 CM2220 F110, ISF3.8 CM2220 F116, ISF3.8 CM2220 F134B, ISF3.8 CM2220 IAN, ISF3.8 CM2350 F109, ISF4.5 CM2220 F123, ISG11 CM2880 G106, ISG11 CM2880 G108, ISG12 CM2880 G107, ISG12 CM2880 G109, ISG12 G CMOH6.0 G111, QSB3.9 30 CM550, QSB3.9 CM2880 B138, QSB4.5 30 CM550, QSB4.5 CM2150 B108, QSB4.5 CM2250 B131, QSB4.5 CM2250 EC, QSB4.5 CM2350 B106, QSB4.5 CM2350 B122			



ft954zq

SMALL | MEDIUM | LARGE

Cart	Ref No	Part Number	Part Description	Required	Remarks
View My Cart					
		FT9094-04	Fuel Plumbing		<a href="#">Fuel Plumbing...(More)</a>
					Engine Family: "B" Series
					Engine Cylinders: 6
					Fitting Type: Male Union
					Fitting Supplier: Cummins
					Orientation: Horizontal
					Cylinder Head Drain Location:
					X: 15.7, Y: 391.7, Z: -756.7
					Fuel Pump Drain Location:

					X: 246.4, Y: 247.2, Z: -66.2
					Common Rail Drain Valve
					Location: X: 222.0, Y: 437.3
					Z: -349.3
<input type="checkbox"/>		3081952	Male Union	1	
<input type="checkbox"/>	1	3046201	O-Ring Seal	1	
	2	3085825	Male Union	1	
<input type="checkbox"/>	3	3922794	O-Ring Seal	1	
<input type="checkbox"/>		3678923	Threaded Plug	1	M10 X 1.00 X 13.5
<input type="checkbox"/>	4	3678924	Threaded Plug	1	M10 X 1.00 X 13.5
<input type="checkbox"/>	5	3678925	O-Ring Seal	1	M10.
<input type="checkbox"/>	6	3902116	Hexagon Flange Head Cap Screw	1	M12 X 1.75 X 50.
<input type="checkbox"/>	7	3089016	Hexagon Flange Head Cap Screw	2	M10 X 1.50 X 35.
<input type="checkbox"/>	8	3903035	Banjo Connector Screw	4	M12 X 1.50 X 24.
<input type="checkbox"/>	9	3910495	Hexagon Flange Head Cap Screw	1	M12 X 1.75 X 30.
<input type="checkbox"/>	10	3957290	Check Valve	1	
<input type="checkbox"/>	11	3958987	Banjo Connector Screw	1	
<input type="checkbox"/>	12	3963983	Sealing Washer	9	M12.
<input type="checkbox"/>	13	3963988	Sealing Washer	2	M14.
<input type="checkbox"/>	14	3966656	Fuel Block Connection	1	
<input type="checkbox"/>	15	3967317	Sealing Washer	1	
<input type="checkbox"/>		3972577	Male Adapter Elbow	1	
<input type="checkbox"/>	16	3975684	O-Ring Seal	1	
	17	3973638	Male Adapter Elbow	1	
<input type="checkbox"/>	18	3972893	Flexible Hose	1	
<input type="checkbox"/>	19	3972894	Flexible Hose	1	
<input type="checkbox"/>	20	3972895	Flexible Hose	1	
<input type="checkbox"/>	21	3972907	Fuel Block Connection Bracket	1	

Need Assistance? Please click on the Contact Us button in the top right corner of any page.